

# **New Zealand 5G base station power module**

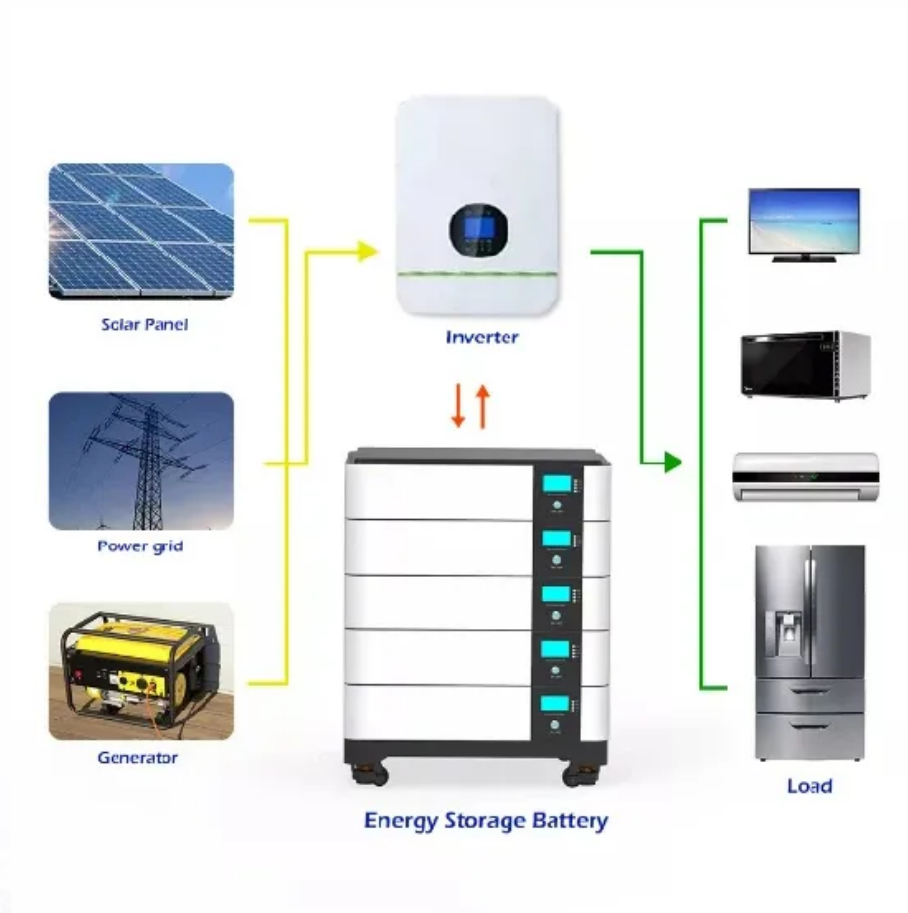



## Overview

---

### What is a 5G NR Network?

As defined in 3GPP TS 38.300, the 5G NR network consists of NG RAN (Next Generation Radio Access Network) and 5GC (5G Core Network). As shown, NG-RAN is composed of gNBs (i.e., 5G Base stations) and ng-eNBs (i.e., LTE base stations). The figure above depicts the overall architecture of a 5G NR system and its components.

### What is a 5G base station?

5G base stations operate on various frequency bands, including sub-6 GHz and mmWave, to deliver ultra-low latency, high data throughput, and enhanced capacity. They support massive MIMO (Multiple Input Multiple Output) technology, enabling improved coverage and simultaneous connections for a large number of devices.

### What is a 5G cell tower?

Get answers to all your questions about 5G cell towers and your health. When you use your cellphone, it connects to the network through a cellsite. Cellsites are also known as cellphone towers or base stations.

### How 5G technology is transforming connectivity?

5G technology is revolutionizing connectivity, and the manufacturers of 5G equipment are leading this transformation. From modems and base stations to RAN, antenna arrays, and core networks, these companies are providing cutting-edge solutions. Leading vendors are offering innovative products to enhance network speed, coverage, and efficiency.

### What is a 5G radio access network?

The 5G Radio Access Network (RAN) is the interface between user devices and the 5G core network. It comprises base stations and small cells that manage radio communications, enabling ultra-fast data transfer and low-latency



connections.

How does a 5G base station reduce OPEX?

This technique reduces opex by putting a base station into a “sleep mode,” with only the essentials remaining powered on. Pulse power leverages 5G base stations’ ability to analyze traffic loads. In 4G, radios are always on, even when traffic levels don’t warrant it, such as transmitting reference signals to detect users in the middle of the night.



## New Zealand 5G base station power module

---



### [Selecting the Right Supplies for Powering 5G Base Stations](#)

These tools simplify the task of selecting the right power management solutions for these devices and, thereby, provide an optimal power solution for 5G base stations components.

### [Product Information](#)

### Power Supply Solutions for Wireless Base Stations Applications

Luckily, MORNSUN has a series of power solutions designed to provide state-of-the-art reliability while also curbing any unnecessary costs related to their installation, application, and ...

### [Product Information](#)

CE UN38.3 MSDS



### [Mitsubishi Electric Achieves World's First Performance ...](#)

Mitsubishi Electric successfully verified its new PAM's performance in a demonstration using 5G-Advanced communication signals for the first time in the world. 1 ...

### [Product Information](#)



### [Cellsites and 5G - Health New Zealand , Te Whatu Ora](#)

Cellsites are also known as cellphone towers or base stations. Cellsites communicate with nearby cellphones using radio signals. These radio signals ...



[Product Information](#)



**5G Base Station Power Supply System:  
NextG Power's Cutting ...**

Discover NextG Power's 5G micro base station power solutions! Our IP65-rated 2000W/3000W modules and 48V 20Ah/50Ah LFP batteries ensure reliable connectivity.

[Product Information](#)



**5G Base Station Complexity Drives the  
Need for Low-EMI DC/DC Module**

Hardware designers are faced with the challenge of finding power solutions that enable all of this additional processing and electronics to be squeezed into form factors similar to those of ...

[Product Information](#)



**5G Base Station Power Supply System:  
NextG Power's Cutting ...**

At NextG Power, we're tackling this challenge with our Reliable & Scalable Power for Next-Generation 5G Networks solution, featuring IP65 waterproof power modules (2000W or ...

[Product Information](#)





### [GaN power amplifier module for 5G mMIMO base stations](#)

Mitsubishi Electric will commence sample shipments of a GaN power amplifier module for 5G mMIMO base stations that can deliver an average output power of 8-W (39 ...

#### [Product Information](#)



### [Selecting the Right Supplies for Powering 5G Base Stations](#)

These tools simplify the task of selecting the right power management solutions for these devices and, thereby, provide an optimal power solution for 5G base stations components.

#### [Product Information](#)

### [5G Base Station Complexity Drives the Need for Low ...](#)

Hardware designers are faced with the challenge of finding power solutions that enable all of this additional processing and electronics to be squeezed into ...

#### [Product Information](#)



### [Which RF Technologies Are Shaping 5G Base Stations?](#)

RF front-end modules in 5G base stations use beamforming to dynamically adjust the direction of signals based on user location and environmental conditions. This targeted ...

#### [Product Information](#)



### [5G Network Equipment Manufacturers: Modem, Base Station, ...](#)

Explore leading 5G equipment manufacturers for modems, base stations, RAN, and core networks. Discover vendors enhancing network speed and efficiency.

#### [Product Information](#)



### [Mitsubishi Electric to Ship Samples of 16W GaN Power ...](#)

Product Features Reduces number of power amplifier modules and extends range of 5G mMIMO base stations Compared to an existing 8W GaN PAM, the new 16W GaN PAM enables a ...

#### [Product Information](#)

### [Powering 5G Infrastructure with Power Modules, RECOM](#)

Discover power module solutions for 5G infrastructure delivering high power density, efficiency, and reliability for base stations and small cell deployments.

#### [Product Information](#)

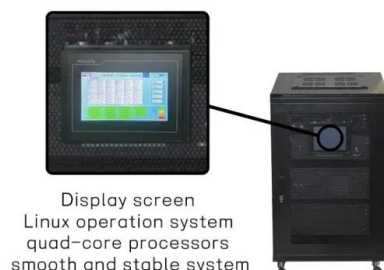

### [Power Consumption Modeling of 5G Multi-Carrier Base ...](#)

Importantly, this study item indicates that new 5G power consumption models are needed to accurately develop and optimize new energy saving solutions, while also considering the ...

#### [Product Information](#)





## Mitsubishi... , MITSUBISHI ELECTRIC US, Inc. Semiconductors ...

Mitsubishi Electric developed its 7GHz GaN PAM using proprietary matching-circuit technology and high-performance GaN transistors. The compact module measures ...

[Product Information](#)



## Mitsubishi Electric to Ship Samples of 3.6-4.0GHz, 16W GaN ...

3.6-4.0GHz, 16W GaN PAM for 5G mMIMO base stations (MGFS52G40MB) TOKYO, March 18, 2025 - Mitsubishi Electric Corporation (TOKYO: 6503) announced today that it will begin ...

[Product Information](#)

## [5g base station power supply solution](#)

Under the impact of these problems, 5g base station power supply with maintenance free, high reliability, diverse installation methods and high IP protection level is one of the best solutions ...

[Product Information](#)



## [The power supply design considerations for 5G base stations](#)

To understand how, consider the power amplifier (PA) and power supply unit (PSU) in the 5G New Radio (NR) gNodeB base station. In 2G, 3G and 4G, the PA and PSU were ...

[Product Information](#)





### [Cellsites and 5G - Health New Zealand . Te Whatu Ora](#)

Cellsites are also known as cellphone towers or base stations. Cellsites communicate with nearby cellphones using radio signals. These radio signals are made up of radiofrequency fields.

#### [Product Information](#)



### **Mitsubishi Electric to Ship Samples of 3.6-4.0GHz, 16W GaN Power**

TOKYO, March 18, 2025 - Mitsubishi Electric Corporation (TOKYO: 6503) announced today that it will begin shipping samples of a new 16W-average-power gallium nitride (GaN) power ...

#### [Product Information](#)

## Contact Us

---

For catalog requests, pricing, or partnerships, please visit:  
<https://les-jardins-de-wasquehal.fr>